

N -Channel Enhancement Mode Power MOSFET

MTE020N10BRJ3

BV_{DSS}	100V
I_D@V_{GS}=10V, T_C=25°C	29A
R_{DS(ON)}@V_{GS}=10V, I_D=20A	24mΩ (typ)

Features

- Low Gate Charge
- Simple Drive Requirement
- Pb-free lead plating and halogen-free package

Equivalent Circuit

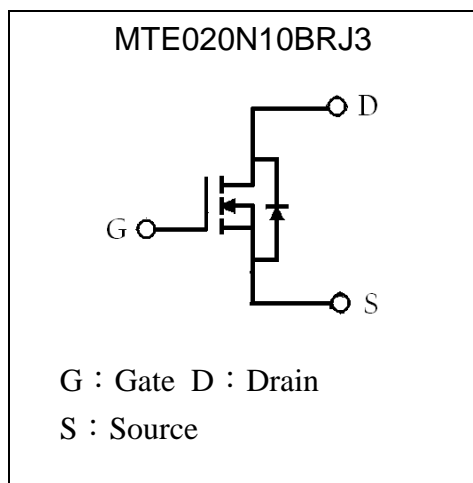

Outline

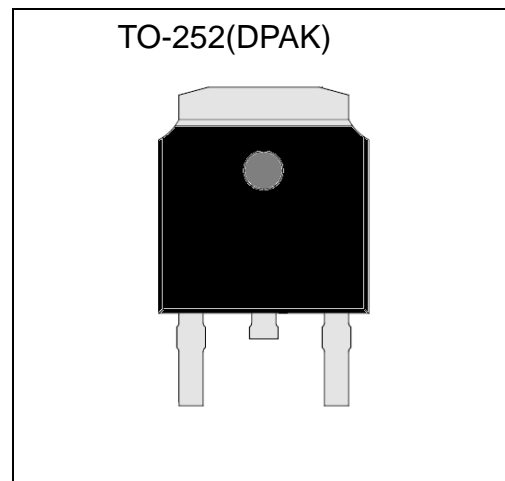

Ordering Information

Device	Package	Shipping
MTE020N10BRJ3-0-T3-G	TO-252 (Pb-free lead plating and halogen-free package)	2500 pcs / Tape & Reel

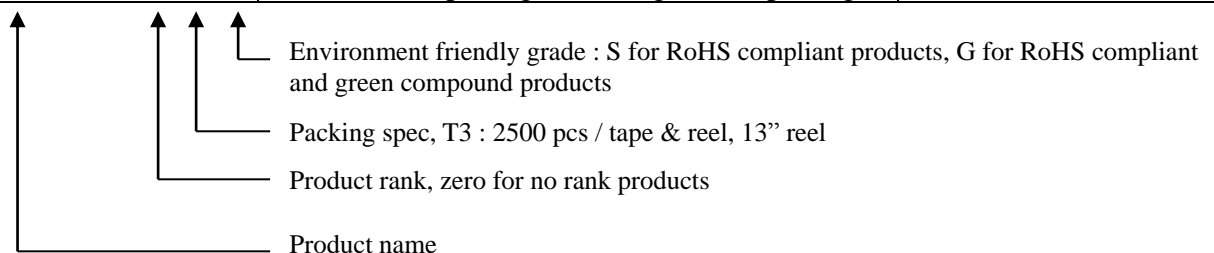



Absolute Maximum Ratings (T_C=25°C, unless otherwise noted)

Parameter	Symbol	Limits	Unit
Drain-Source Voltage	V _{DS}	100	V
Gate-Source Voltage	V _{GS}	±20	
Continuous Drain Current @ T _C =25°C, V _{GS} =10V	I _D	29	A
Continuous Drain Current @ T _C =100°C, V _{GS} =10V		18	
Continuous Drain Current @ T _A =25°C, V _{GS} =10V *4		6.5	
Continuous Drain Current @ T _A =70°C, V _{GS} =10V *4		5.2	
Pulsed Drain Current *1	I _{DM}	116	
Avalanche Current @ L=0.1mH	I _{AS}	22	
Avalanche Energy @ L=0.1mH, I _{AS} =22A, V _{DD} =25V, V _{GS} =10V *3	E _{AS}	24	mJ
Repetitive Avalanche Energy @ L=0.05mH *1, *2	E _{AR}	5	
Total Power Dissipation @T _C =25°C	P _D	50	W
Total Power Dissipation @T _C =100°C		20	
Total Power Dissipation @T _A =25°C *4		2.5	
Total Power Dissipation @T _A =70°C *4		1.6	
Operating Junction and Storage Temperature Range	T _j , T _{stg}	-55~+150	°C

Thermal Data

Parameter	Symbol	Value	Unit
Thermal Resistance, Junction-to-case, max	R _{θJC}	2.5	°C/W
Thermal Resistance, Junction-to-ambient, max *4	R _{θJA}	50	
Thermal Resistance, Junction-to-ambient, max		110	

- Note : *1. Pulse width limited by maximum junction temperature
 *2. Duty cycle ≤ 1%
 *3. 100% tested by conditions of L=0.1mH, I_{AS}=12A, V_{GS}=10V, V_{DD}=25V
 *4. Surface mounted on 1 in² copper pad of FR-4 board

Characteristics (T_C=25°C, unless otherwise specified)

Symbol	Min.	Typ.	Max.	Unit	Test Conditions
Static					
BV _{DSS}	100	-	-	V	V _{GS} =0V, I _D =250μA
ΔBV _{DSS} /ΔT _j	-	0.08	-	V/°C	Reference to 25°C, I _D =250μA
V _{GS(th)}	2	-	4	V	V _{DS} = V _{GS} , I _D =250μA
G _{FS} *1	-	7.2	-	S	V _{DS} = 10V, I _D =10A
I _{GSS}	-	-	±100	nA	V _{GS} =±20V, V _{DS} =0V
I _{DSS}	-	-	1	μA	V _{DS} = 100V, V _{GS} = 0V
	-	-	25		V _{DS} = 80V, V _{GS} = 0V, T _j =125°C
R _{DS(ON)} *1	-	24	34	mΩ	V _{GS} = 10V, I _D =20A
Dynamic					
Q _g *1, 2	-	13.8	-	nC	I _D =20A, V _{DS} =50V, V _{GS} =10V
Q _{gs} *1, 2	-	5.6	-		
Q _{gd} *1, 2	-	3	-		

$t_{d(ON)}$ *1, 2	-	12.4	-	ns	$V_{DS}=50V, I_D=20A, V_{GS}=10V, R_G=3\Omega$
t_r *1, 2	-	14.6	-		
$t_{d(OFF)}$ *1, 2	-	19	-		
t_f *1, 2	-	6.2	-		
C_{iss}	-	877	-	pF	$V_{GS}=0V, V_{DS}=50V, f=1MHz$
C_{oss}	-	109	-		
C_{rss}	-	27	-		
R_g	-	1.4	-	Ω	$f=1MHz$
Source-Drain Diode					
I_S *1	-	-	29	A	
I_{SM} *3	-	-	116		
V_{SD} *1	-	0.92	1.2	V	$I_S=20A, V_{GS}=0V$
t_{rr}	-	30.4	-	ns	$I_F=20A, dI_F/dt=100A/\mu s$
Q_{rr}	-	41.3	-	nC	

Note : *1.Pulse Test : Pulse Width $\leq 300\mu s$, Duty Cycle $\leq 2\%$
 *2.Independent of operating temperature
 *3.Pulse width limited by maximum junction temperature.

Recommended soldering footprint

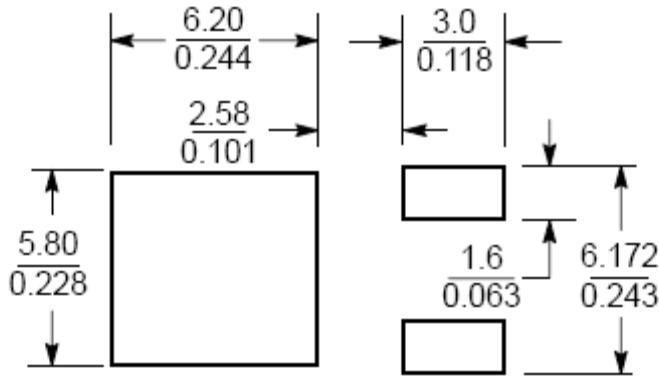

Unit ($\frac{mm}{inch}$)

Typical Characteristics

Typical Output Characteristics

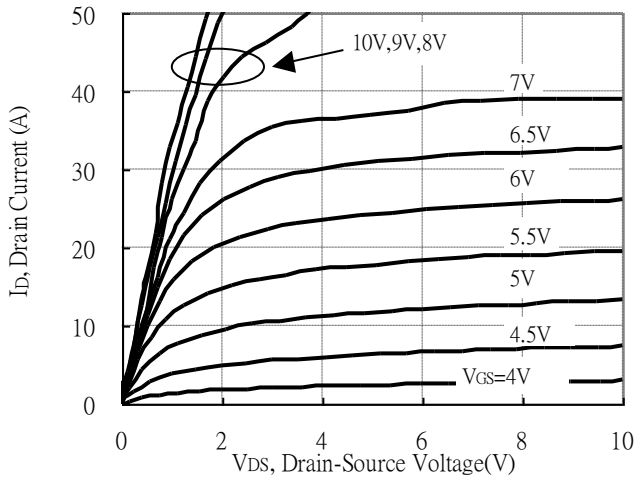

Brekdown Voltage vs Ambient Temperature

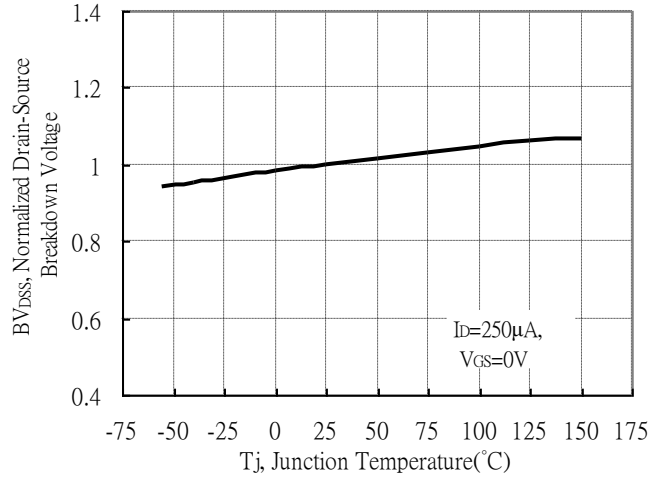

Static Drain-Source On-State resistance vs Drain Current

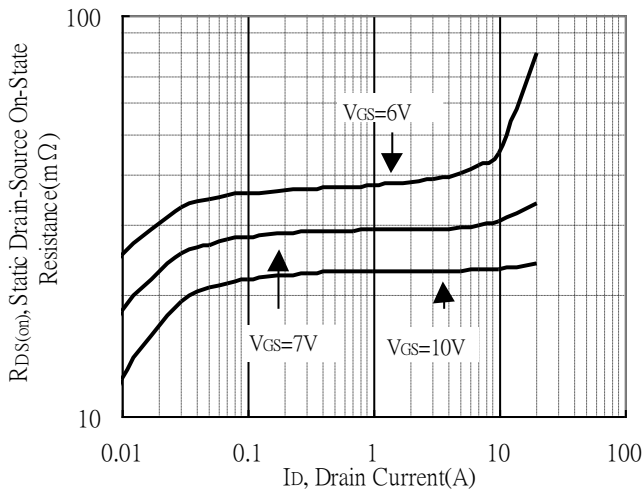

Reverse Drain Current vs Source-Drain Voltage

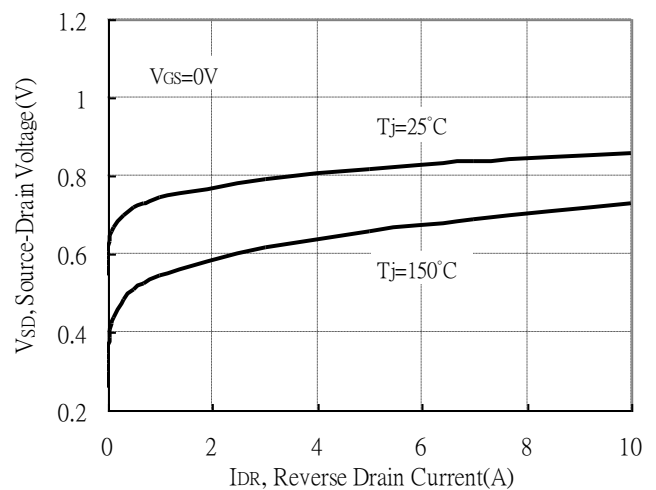

Static Drain-Source On-State Resistance vs Gate-Source Voltage

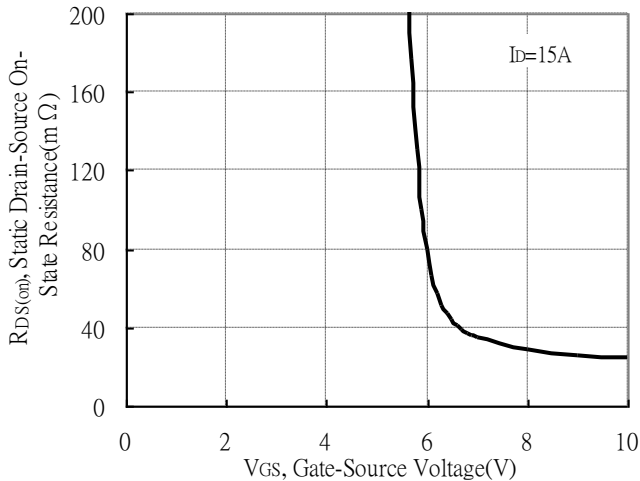

Drain-Source On-State Resistance vs Junction Temperature

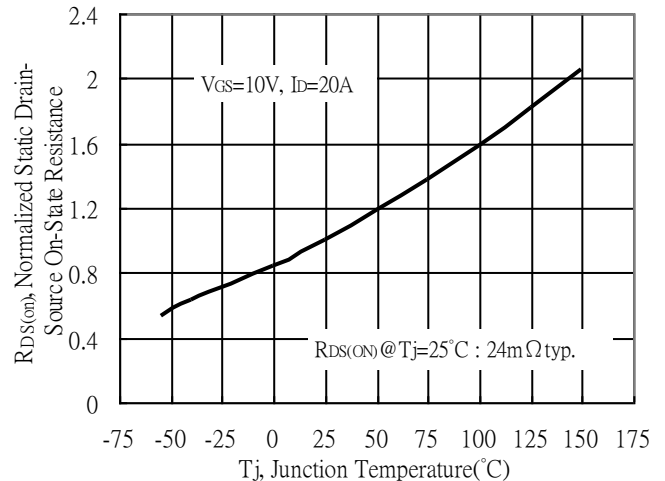

Typical Characteristics(Cont.)

Capacitance vs Drain-to-Source Voltage

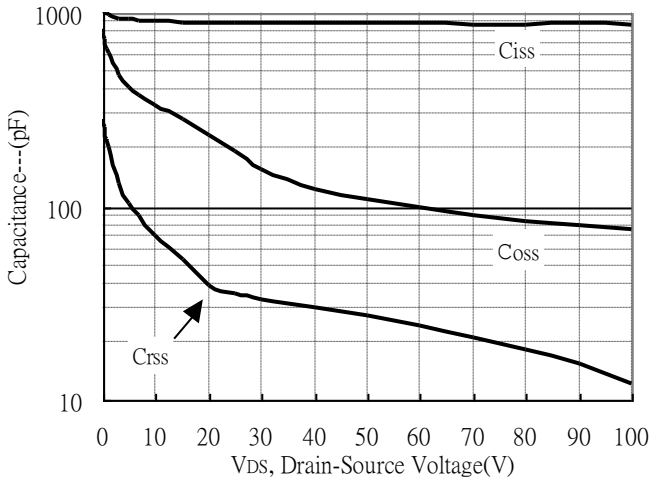

Threshold Voltage vs Junction Temperature

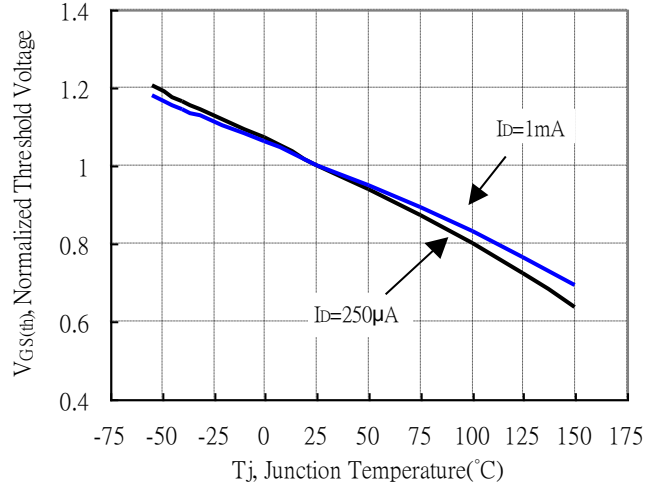

Forward Transfer Admittance vs Drain Current

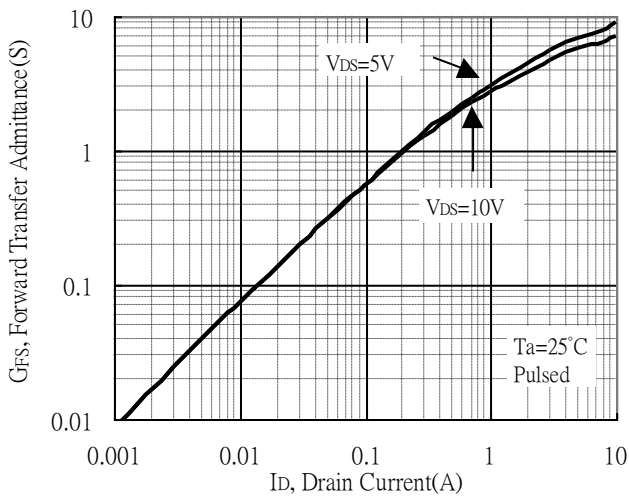

Gate Charge Characteristics

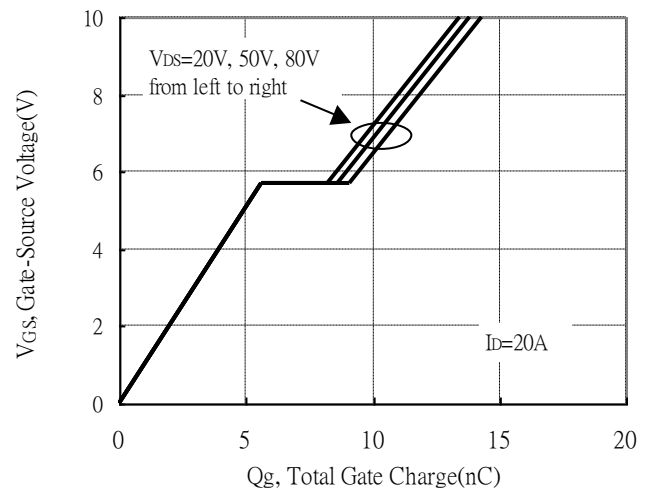

Maximum Safe Operating Area

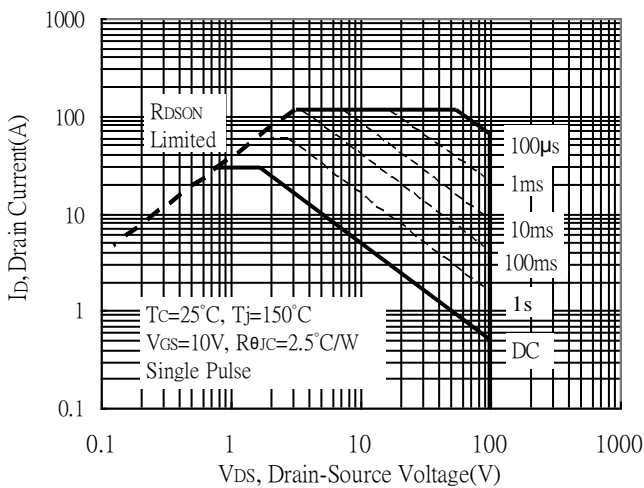

Maximum Drain Current vs Case Temperature

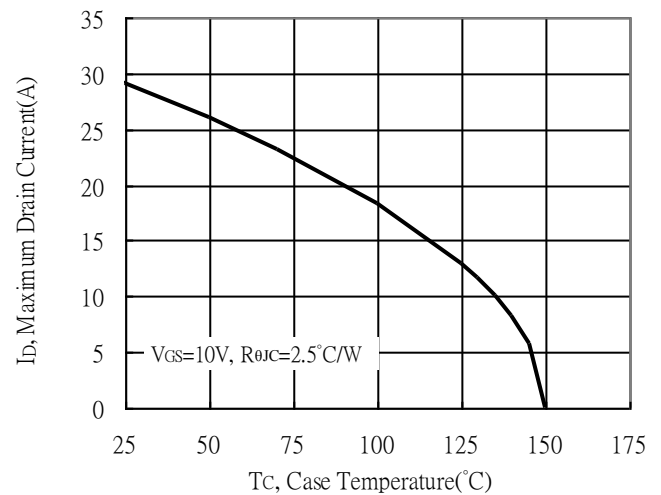

Typical Characteristics(Cont.)

Typical Transfer Characteristics

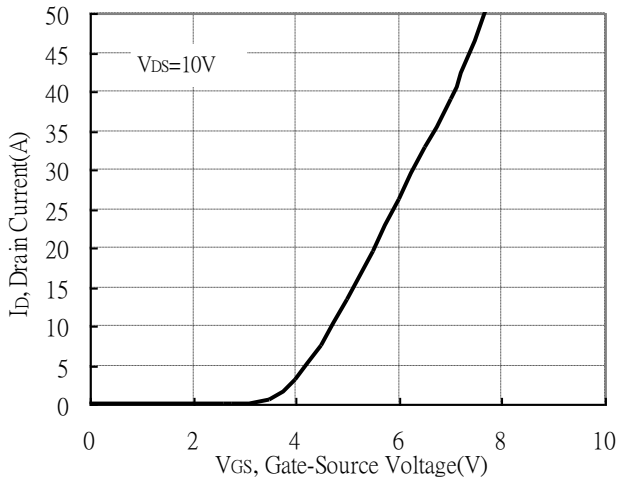

Single Pulse Power Rating, Junction to Case

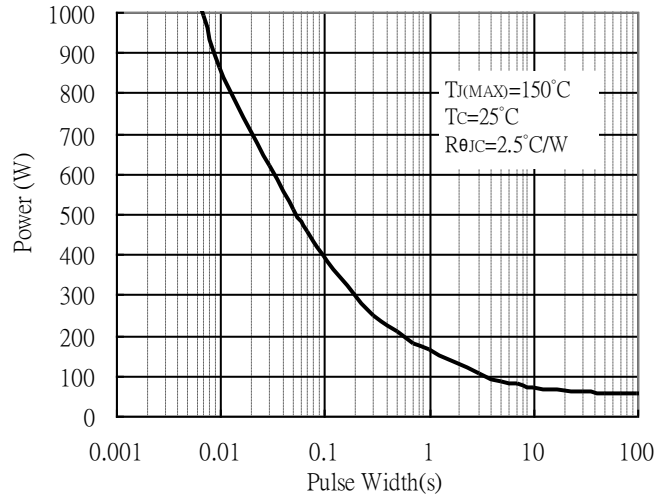

Transient Thermal Response Curves

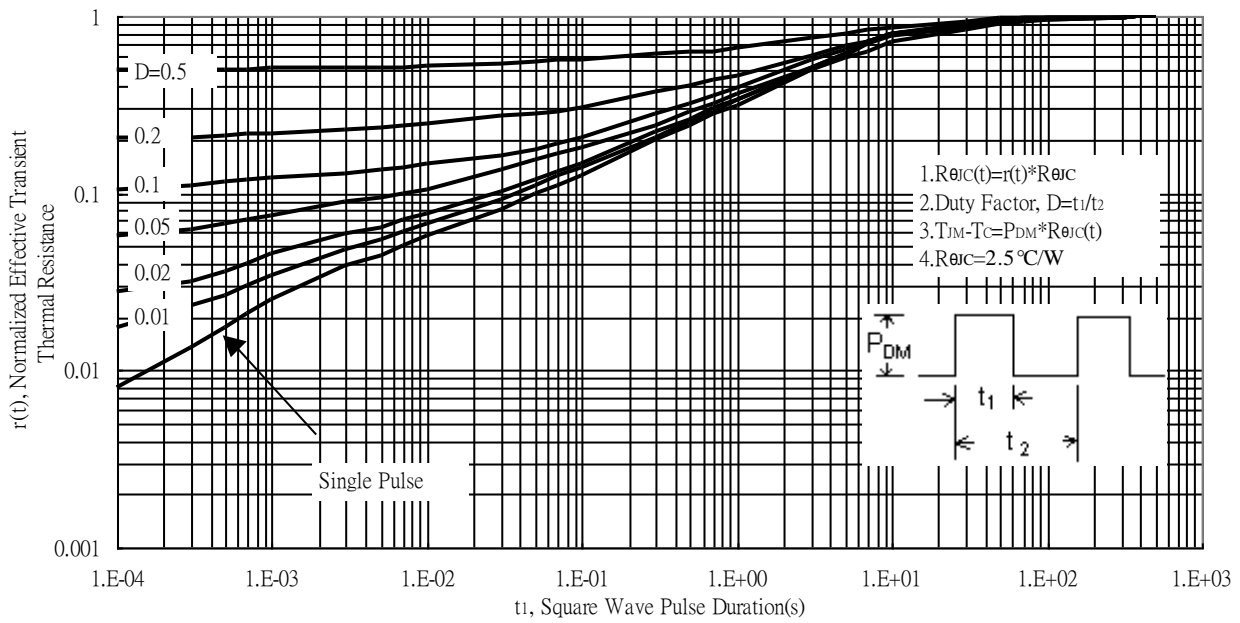

Reel Dimension

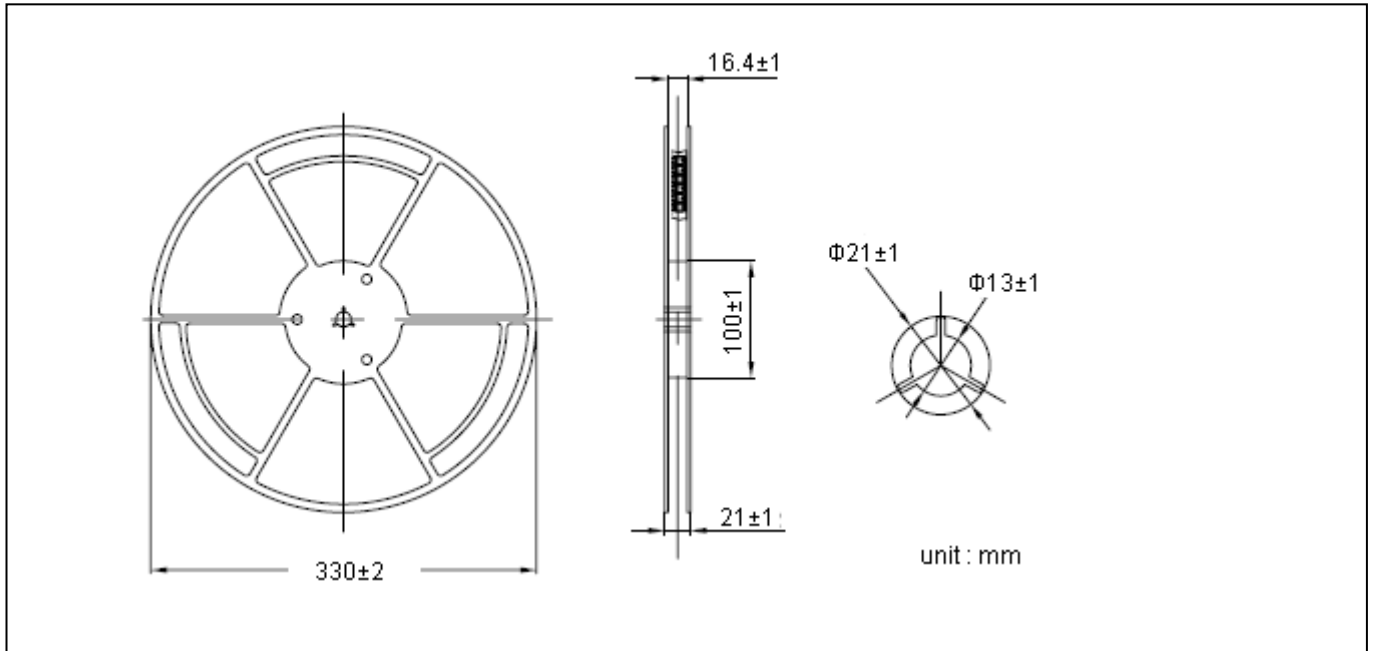

Carrier Tape Dimension

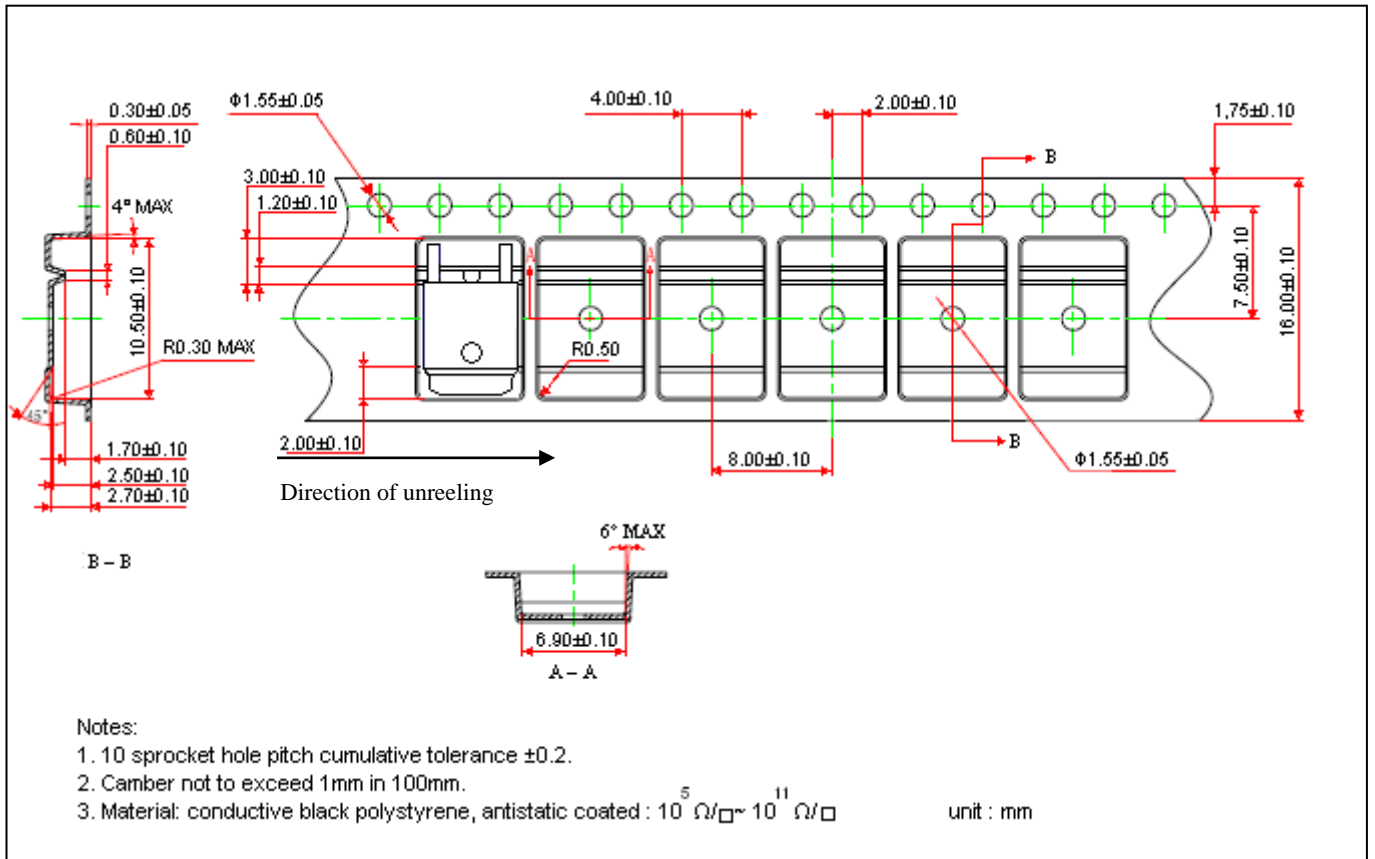

Recommended wave soldering condition

Product	Peak Temperature	Soldering Time
Pb-free devices	260 +0/-5 °C	5 +1/-1 seconds

Recommended temperature profile for IR reflow

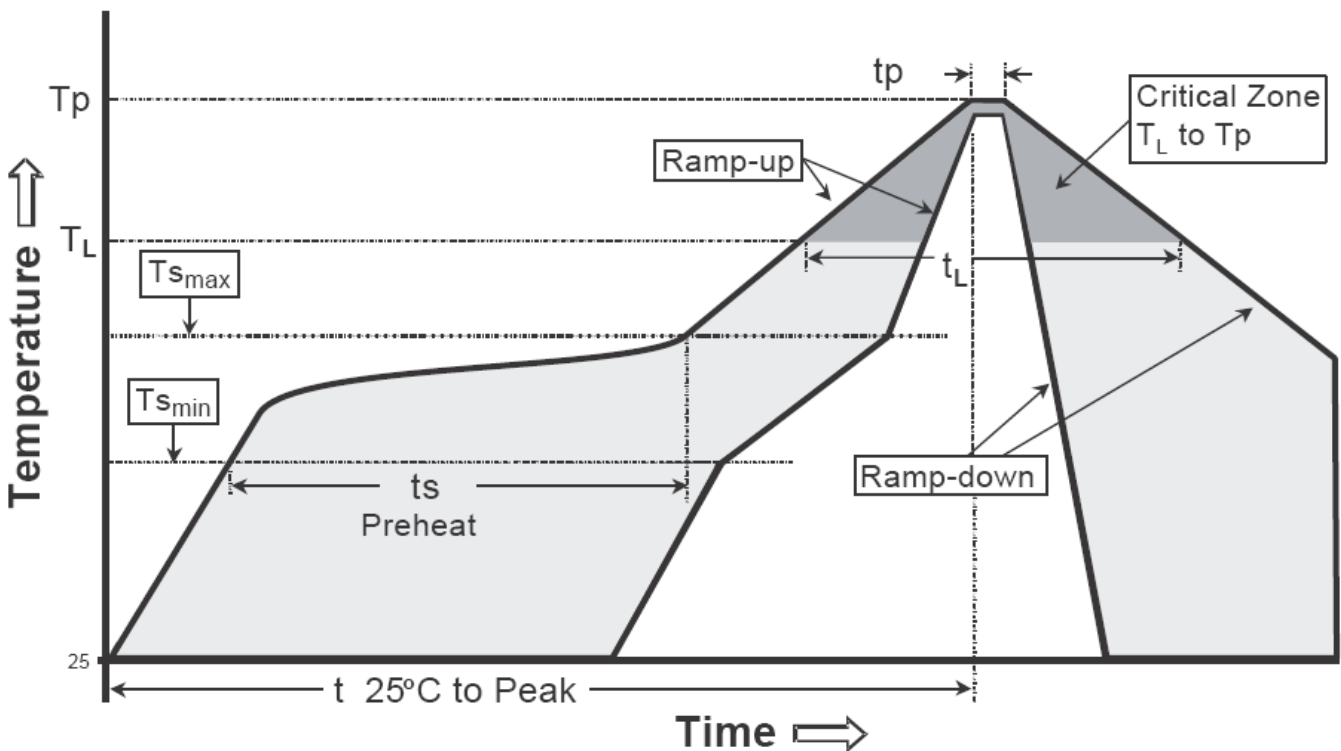

Profile feature	Sn-Pb eutectic Assembly	Pb-free Assembly
Average ramp-up rate (T _{smax} to T _p)	3°C/second max.	3°C/second max.
Preheat		
-Temperature Min(T _{s min})	100°C	150°C
-Temperature Max(T _{s max})	150°C	200°C
-Time(t _{s min} to t _{s max})	60-120 seconds	60-180 seconds
Time maintained above:		
-Temperature (T _L)	183°C	217°C
- Time (t _L)	60-150 seconds	60-150 seconds
Peak Temperature(T _P)	240 +0/-5 °C	260 +0/-5 °C
Time within 5°C of actual peak temperature(tp)	10-30 seconds	20-40 seconds
Ramp down rate	6°C/second max.	6°C/second max.
Time 25 °C to peak temperature	6 minutes max.	8 minutes max.

Note : All temperatures refer to topside of the package, measured on the package body surface.

TO-252 Dimension

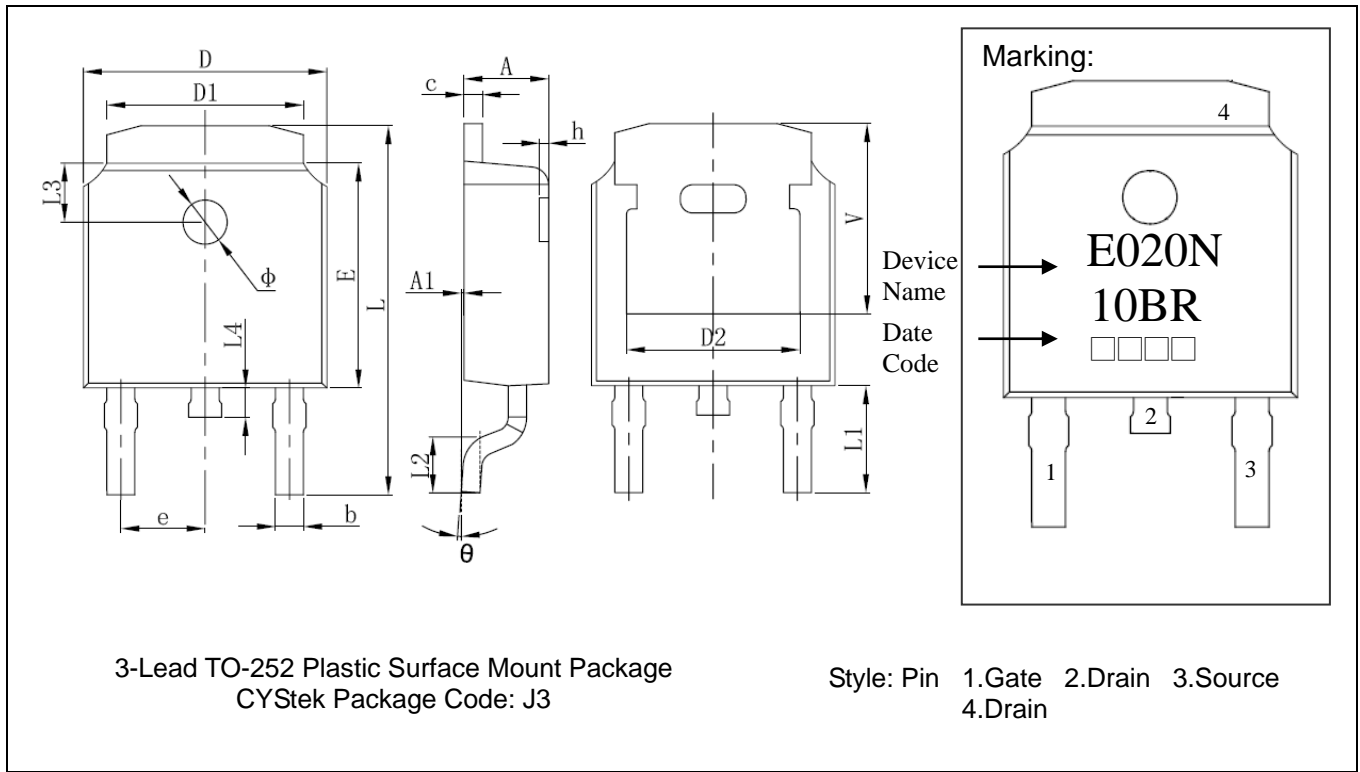

DIM	Inches		Millimeters		DIM	Inches		Millimeters	
	Min.	Max.	Min.	Max.		Min.	Max.	Min.	Max.
A	0.087	0.094	2.200	2.400	L	0.382	0.406	9.712	10.312
A1	0.000	0.005	0.000	0.127	L1	0.114	REF	2.900	REF
b	0.025	0.030	0.635	0.770	L2	0.055	0.067	1.400	1.700
c	0.018	0.023	0.460	0.580	L3	0.063	REF	1.600	REF
D	0.256	0.264	6.500	6.700	L4	0.024	0.039	0.600	1.000
D1	0.201	0.215	5.100	5.460	Φ	0.043	0.051	1.100	1.300
D2	0.190	REF	4.830	REF	θ	0°	8°	0°	8°
E	0.236	0.244	6.000	6.200	h	0.000	0.012	0.000	0.300
e	0.086	0.094	2.186	2.386	v	0.207	REF	5.250	REF

Notes: 1.Controlling dimension: millimeters.
 2.Maximum lead thickness includes lead finish thickness, and minimum lead thickness is the minimum thickness of base material.
 3.If there is any question with packing specification or packing method, please contact your local CYStek sales office.

Material:

- Lead : Pure tin plated.
- Mold Compound: Epoxy resin family, flammability solid burning class: UL94V-0.

Important Notice:

- All rights are reserved. Reproduction in whole or in part is prohibited without the prior written approval of CYStek.
- CYStek reserves the right to make changes to its products without notice.
- CYStek **semiconductor products are not warranted to be suitable for use in Life-Support Applications, or systems.**
- CYStek assumes no liability for any consequence of customer product design, infringement of patents, or application assistance.